



ZIMBABWE SCHOOL EXAMINATIONS COUNCIL
General Certificate of Education Advanced Level

BUILDING TECHNOLOGY & DESIGN

6003/3

PAPER 3 Practical Test

SPECIMEN PAPER

Additional materials:

5 hours

Answer paper,
A3 drawing paper,
Scientific calculator,
ICT software.

INSTRUCTIONS TO CANDIDATES

Answer the question on the answer paper provided.

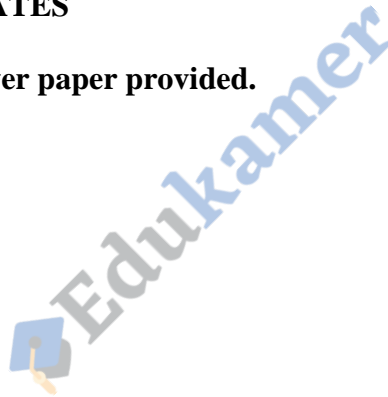

This question paper consists of 3 printed pages and 1 blank page.

Copyright: Zimbabwe School Examinations Council, Specimen paper.

©ZIMSEC Specimen paper

[Turn over

- 1 **Figure 1** below is a plan of a church to be built. Study the plan and use it to answer the questions that follow.

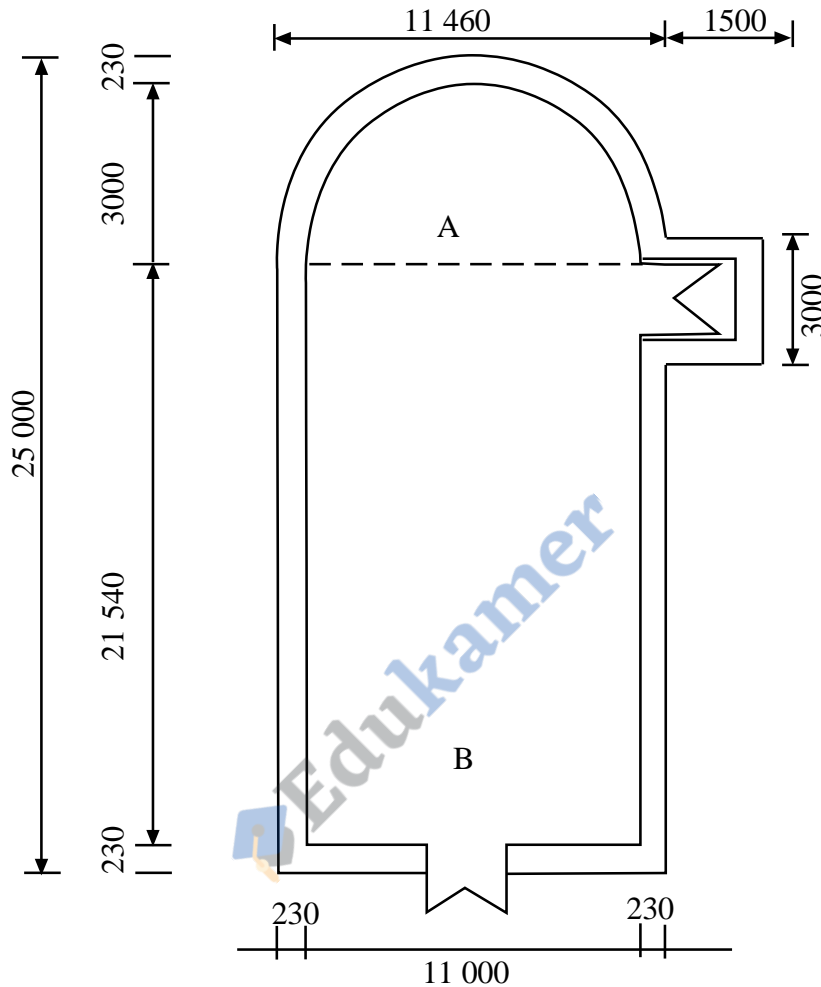

Fig. 1

- (a) (i) Prepare a sequential outline of the processes involved in constructing the church. [10]
- (ii) Design a gnatt chart works programme of the processes listed in (i). [10]
- (iii) Copy the drawing on an A3 paper and show possible site layout of the hutment at preliminary stage of construction. [18]
- (iv) Compile a list of tools needed for setting out the building. [5]
- (v) List and describe the methods to be used in setting out **Part A** and **Part B** of the building. [8]

- (b) (i) Redraw the plan of the church in **Figure 1** and show positions of the following:
- datum peg,
- side and corner profiles,
- ranging lines,
- foundation boundaries. [20]
- (ii) Show on the drawing, how the accuracy of setting out is checked. [10]
- (c) (i) Illustrate how ranging lines are transferred from profiles on to the base of the foundation. [9]
- (ii) Show how the door frame shown in **Figure 1** can be secured into the walls of the building. [10]



4
BLANK PAGE

